

10-17-11  
 EUCLID CH 120

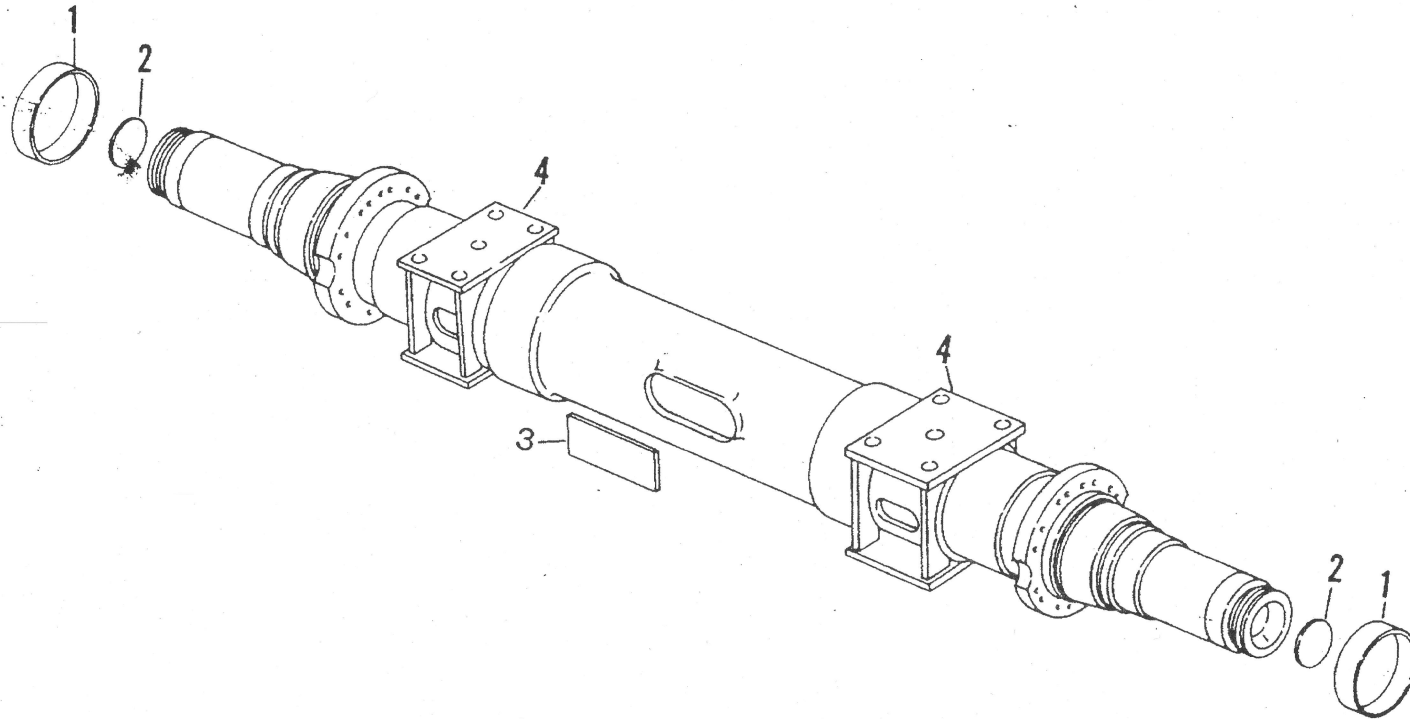

AXLE

N.C.	REF	QTY	PART NO	PART NAME
		1	4006873	AXLE ASSY.
C	1	2	4006256	SLEEVE
	2	2	9177011	PLATE

N.C.	REF	QTY	PART NO	PART NAME
	3	2	9215334	BAR
	4	2	4005656	SUPPORT ASSY.

NOTE- REFER TO SECTION 10-4-0 FOR MATING SEAL. WHEN REPLACING SLEEVE, USE 2-~~9195637~~ BUSHING AND 2-9195902 SEAL-OIL. 4039507

Always give SERIAL NUMBER when ordering parts

Names of parts included in an assembly are indented after each assembly or sub-assembly

LITHO IN U.S.A.

FORM

800978-R2

10-1-0-8

E-24.00 X 49-36 OR 42 PLY

WHEEL, RIM AND TUBELESS

TRAILER  
WHEEL  
CH 120

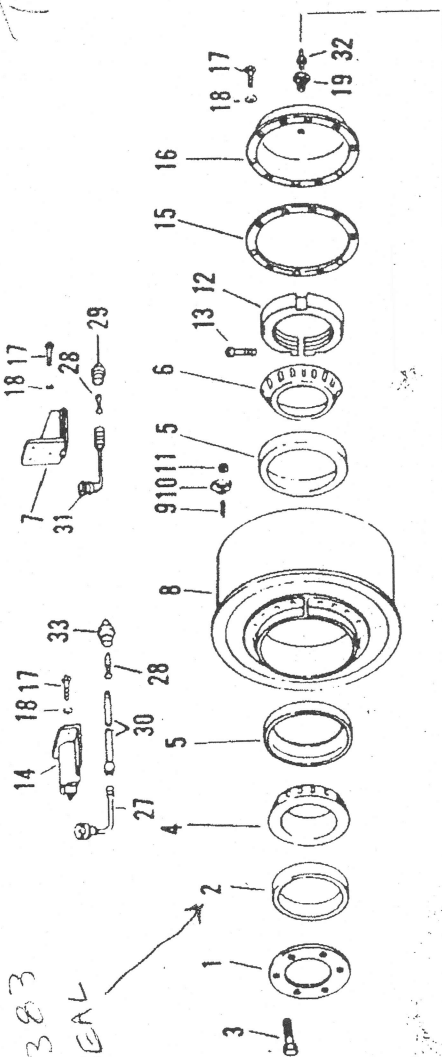

416383  
SEAL

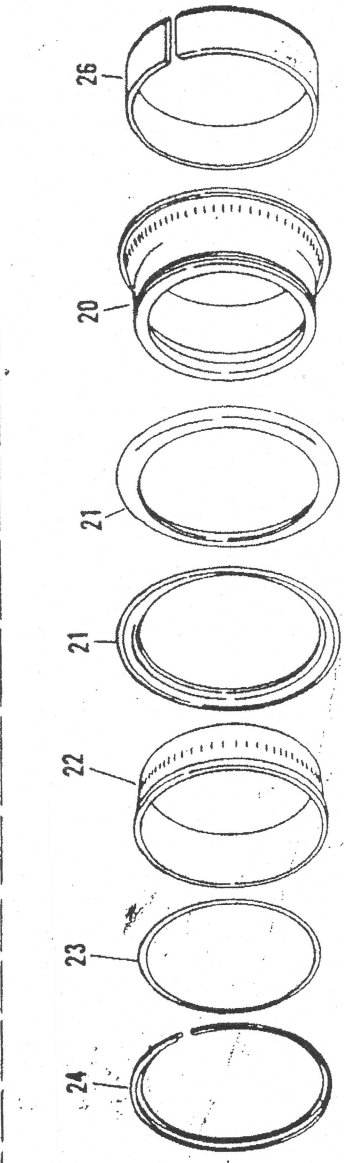
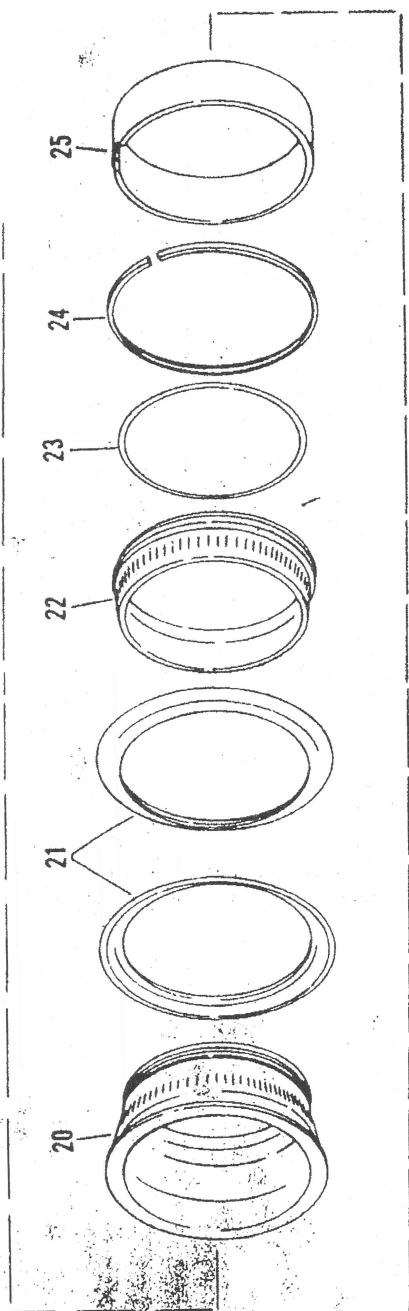

WHEEL, RIM AND TUBELESS TIRE-24.00 X 49-36 OR 42 PLY

REF	QTY	PART NO	PART NAME	REF	QTY	PART NO	PART NAME	
			<i>REPL BY 9195902</i>					
	1	9219607	GUARD	17	15	179883	BOLT	
C	2	4006255	SEAL 416383	18	15	103329	LOCKWASHER	
	3	9219509	SCREW	19	1	128004	BUSHING	
	4	9415325	CONE-INNER	D	20	2	4006292	RIM
	5	9415326	CUP-INNER AND OUTER		21	4	4002743	FLANGE
	6	9217007	CONE-OUTER		22	2	4002742	BAND-BEAD SEAT
	7	9237373	GUARD-OUTER		23	2	9209490	RING-O
	8	9237373	WHEEL	DE	24	2	4006293	RING-LOCK
	9	9216458	STUD		25	1	4017444	BAND SPACER
	10	9219583	CLAMP		26	1	4017443	BAND WEDGE
	11	9056740	NUT		27	1	4021446	VALVE ASSY-INNER
	12	4010089	LOCKNUT		28	2	9142286	CORE
	13	4010749	BOLT		29	1	4023770	CAP-OUTER
	14	9237376	GUARD-INNER		30	1	4023364	EXTENSION
	15	9214978	GASKET		31	1	4021445	VALVE ASSY-OUTER
	16	9214976	CAP		32	1	178779	VALVE
					33	1	4023770	CAP

C NOTE- SEE SEC. 10-1-0 FOR MATING SLEEVE. WHEN REPL. SEAL USE 1-4006255 SEAL. WHEN  
 REPL. SEAL AND SLEEVE USE 1-9195902 SEAL AND 1-9195637 BUSHING. → 4039507  
 D NOTE- HAS BEEN SUPERSEDED BY 4049649 BASE-RIM AND 4045762 RING-LOCK.  
 E NOTE- DO NOT USE OLD RING LOCK WITH NEW BASE-RIM.

BRAKE PARTS- IT HAND-30 X 10

\* NOT SOLD SEPARATELY  
INCLUDED IN KIT

\*\* NOT SOLD SEPARATELY

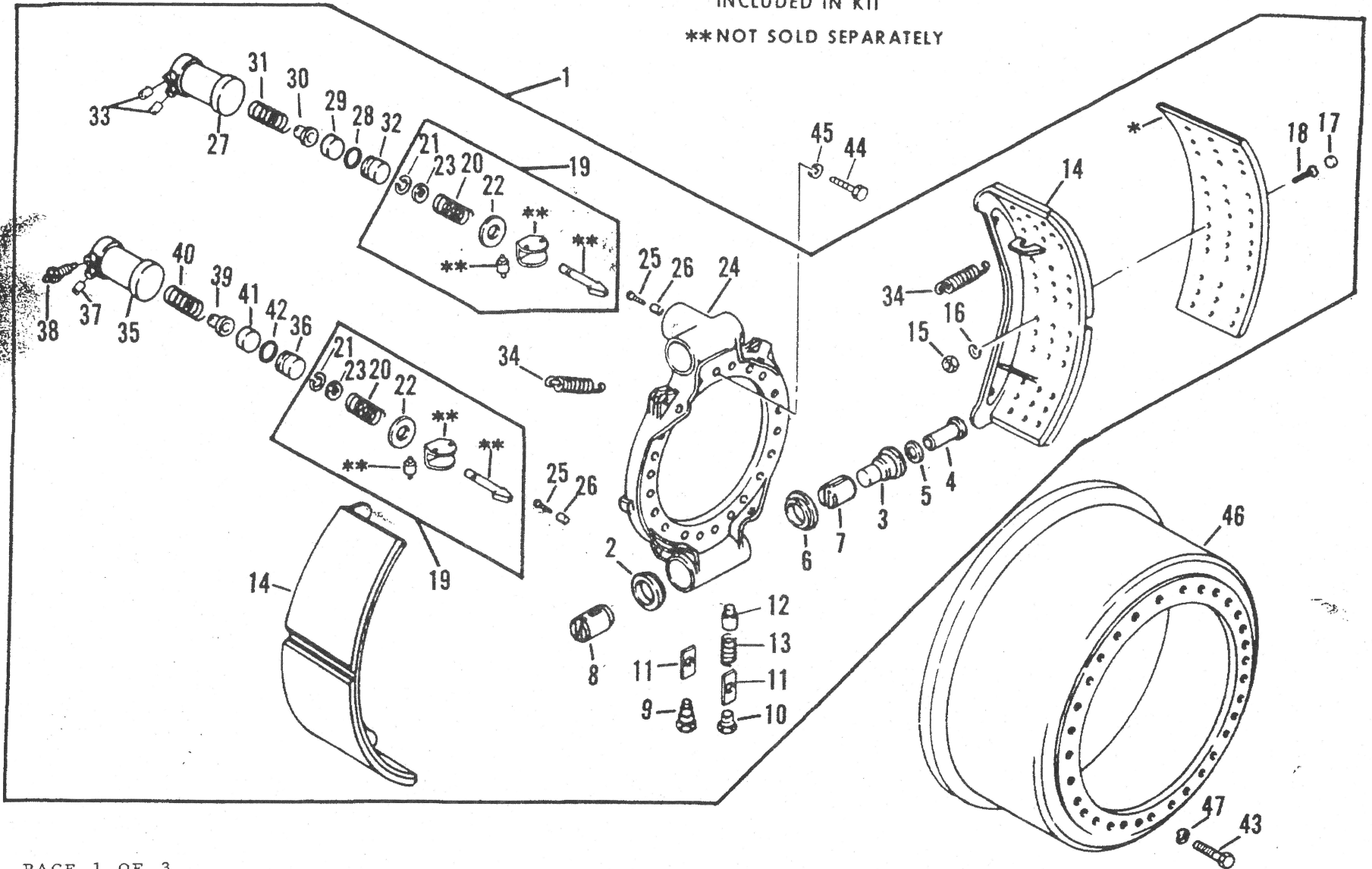

BRAKE PARTS-RIGHT HAND-30 X 10

	REF	QTY	PART NO	PART NAME		REF	QTY	PART NO	PART NAME
		1	4021631	BRAKE ASSY.		25	2	102453	. SCREW
		2	9034565	. SEAL		26	2	2449413	. PLUG
I		3	4023887	. ADJUSTER		27	1	4015895	. CYLINDER ASSY.
		4	9034573	. BOLT	D	28	1	9122577	. . RING-O
		5	9034933	. SEAL	D	29	1	9034566	. . CUP
		6	9034565	. SEAL	D	30	1	9034587	. . PLUG
		7	9034584	. PLUNGER	D	31	1	9034583	. . SPRING
		8	9034585	. ANCHOR	D	32	1	9034578	. . PISTON
I		9	9034575	. GUIDE		33	2	9034576	. . SEAT
I		10	4023888	. BOLT		34	8	9034582	. SPRING
		11	2460308	. PLATE		35	1	4015897	. CYLINDER ASSY.
		12	4023889	. GUIDE	E	36	1	9034578	. . PISTON
I		13	9034581	. SPRING		37	1	9034576	. . SEAT
F		14	4016800	. SHOE ASSY.		38	1	9034570	. . SCREW
CGH		15	56 102635	. . NUT	E	39	1	9034587	. . PLUG
CGH		16	56 103321	. . LOCKWASHER	E	40	1	9034583	. . SPRING
		17	50 4023891	. . PLUG	E	41	1	9034566	. . CUP
CGH		18	56 4031461	. . BOLT	E	42	1	9122577	. . RING-O
		19	2 4017872	. WEDGE ASSY.		43	32	223770	BOLT
		20	1 4015891	. . SPRING		44	20	223489	BOLT
		21	1 9147875	. . RING		45	20	4018311	WASHER
		22	1 4015892	. . WASHER		46	1	4013058	DRUM
		23	1 4015893	. . WASHER		47	32	4018330	WASHER
		24	1 4023894	. SPIDER					

C NOTE- ASR-4053807 KIT-LINING-STD. INCLUDES 114-4031461 BOLT, 114-4023891 PLUG, 4-LINING, 114-4059265 NUT.

D NOTE- 4031086 KIT\_CYLINDER CONSISTS OF THE NECESSARY PARTS TO SERVICE ONE CYLINDER.

E NOTE- 4031086 KIT-CYLINDER CONSISTS OF THE NECESSARY PARTS TO SERVICE ONE CYLINDER.

F NOTE- SUPERSEDED BY 4059037 SHOE ASSY.

G NOTE- ASR-4031100 KIT-LINING-1/16 OS CONSISTS OF 114-4031461 BOLT, 114-4023891 PLUG, 4-LININGS, 114-4059265 NUT.

CONTINUED ON NEXT PAGE

MADE IN U.S.A.

BRAKE PARTS-RIGHT HAND-30 X 10

- H NOTE- ASR-4031101 KIT LINING-1/8 O.S. CONSISTS OF 114-4031461 BOLT, 114-4023891 PLUG,  
4-LINING, 114-4059265 NUT.
- I NOTE- THESE PARTS ARE REPLACED AS A GROUP BY USING 4062239 KIT. SEE NOTE J.
- J NOTE- KIT CONSISTS OF 2-4062240 GUIDE PAWL ASSY., 2-4062241 ACTUATOR, 2-4047476 BOLT ASSY.,  
2-9034565 SEAL ASSY., 2-4047471 TAG.

PAGE 3 OF 3

FORM

802474-R15

10-5-0-42

LITHO IN U.S.A.

From: Rimpull

913+782+2651

10/17/2011 11:08

#845 P.007/007